

# C&K F Series Pushbutton Switches

## SOLID BUTTON

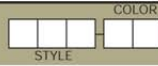

### STYLE

**F01** FMR

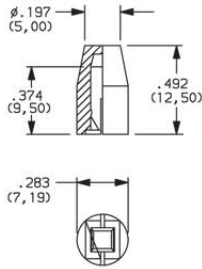

**F02** FG

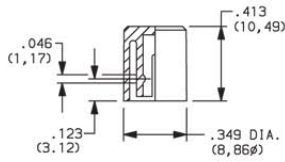

**F12** FSC

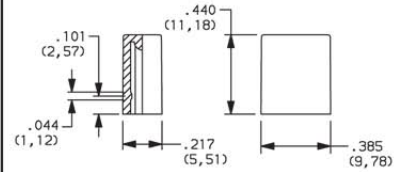

**F13** FSD

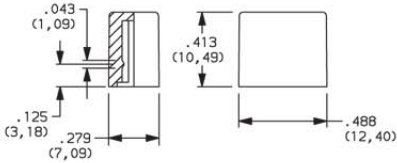
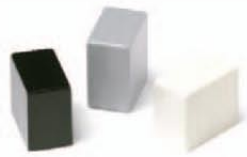

**F14** FU12

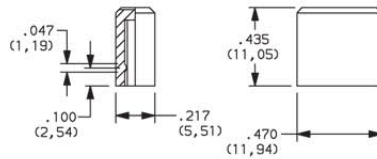
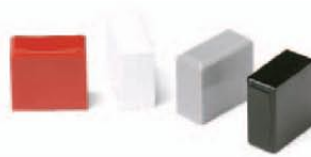

**F03** F1.12-H-5

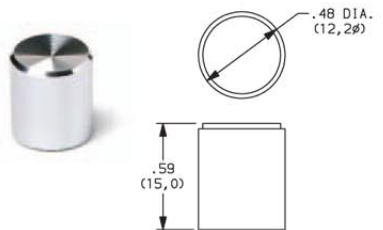

**F06** F1.12-H-4

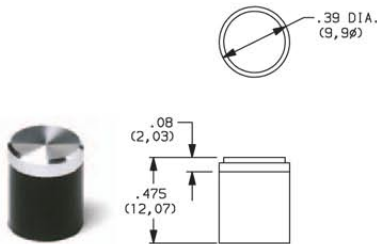

**F07** F1.15-H-4

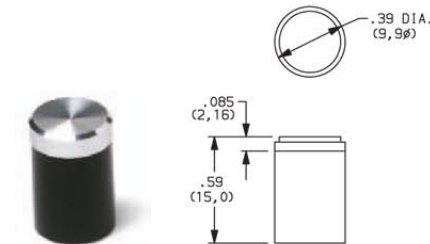

OPTION CODE	COLOR
<b>01</b>	(STD.) BLACK
<b>02</b>	WHITE
<b>03</b>	RED
<b>04</b>	LT. GRAY
<b>09</b>	BLACK/CHROME (F03, F06 & F07 buttons only)



Dimensions are shown: IN (mm)  
Dimensions subject to change